

Diamond Star Round

Saltwater Friendly

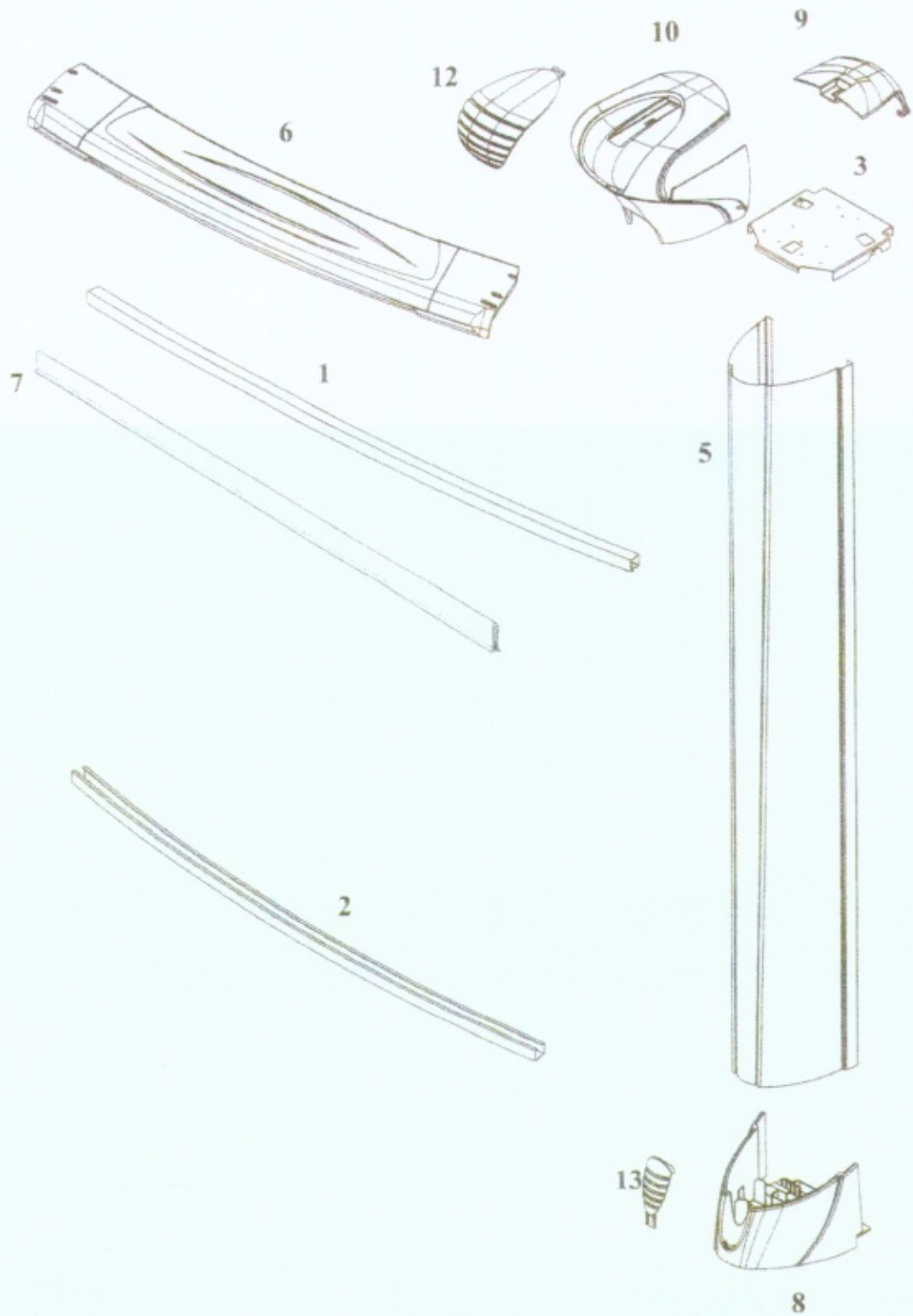

WBI Pool Breakout

PMEA-1554RPRRRE1

MEADOWS ROUND 15 Ft 15-54 RPRRRE1

Features: ROUND
Size: 15 Ft
Depth: 54

10.00

Structure Composition

RESIN - PEARL Top Ledges
PAINTED STEEL - DAMASK Uprights
RESIN Bottom Rails
RESIN Stabilizers
RESIN Bottom Plates
STEEL Top Plates

Note: Double click on carton product search key to see content sheet

| Qty | Carton Part # | Carton Content Description |
|-----|---------------|----------------------------------|
| 1 | CRMEA15-RRRE1 | CTN: MEA 15 CRV-SIDE COMP |
| 1 | CRMEATR-10R | CTN: MEA CRV-SIDE FRAME COMP |
| 1 | CRMEAUP54-10 | CTN: MEA 54" CRV-SIDE FRAME COMP |
| 1 | *** WALL *** | Wall - Depth: 54" Size: 15 Ft |

10/3/2022

Content Sheet

CRMEA15-RRRE1 -- CTN: MEA 15 CRV-SIDE COMP

| PIC # | | | DESCRIPTION |
|-----------|----|-------|---|
| 7 | 12 | 10296 | PLASTIC COPING SINGLE 48" FOR METAL STAB |
| 2 | 10 | 12312 | BTM RAIL (LX) PRL RESIN 7"6" R CMN 54-1/4" ORANGE |
| 10 | 10 | 21378 | TC 10" DAMASK OUTER HALF CVD [E1] |
| 9 | 10 | 21380 | TC 10" DAMASK INNER HALF [E1] |
| | | | TC 10" DAMASK BOOT CVD [E1] |
| 3 | 10 | | TOP PLATE 9" OCEANIC |
| 1 | 10 | | INR STAB SQ RESIN CONNECTOR 5 1/2" |
| | 1 | | SHARKLINE CONSUMER DVD |
| 12 | 10 | | TC 10" MEADOWS CAP GRILL TAN PPC |
| 13 | 10 | | TC 10" MEADOWS BOOT CUFF GRILL TAN PPC |
| 1 | 10 | | RIM 5/8" SQ RSN 7"0"R 58-1/16" |
| | 1 | | HARDWARE POOL KIT SS 309 |
| | 1 | | SHARKLINE WARRANTY TERMS & CONDITIONS |
| | 1 | | ENVELOPES SAFETY COMPLETE |
| Packaging | | | |
| | 1 | | CARTON-EMPTY [ZXT] ID 68-1/16X26X9-58 ECT48 BOT |
| | 1 | | CARTON-EMPTY [ZXT] ID 68-5/16X21-1/2X9-3/4 ECT48 TOP |
| | 2 | | CARTON-SCORED SHEET [ZXT] 78-1/2 X19-3/4X11-1/2 ECT48 |

NOTICE: Please make sure you save this document with your original pool purchase records. It contains vital information to assist us in identifying your pool should you ever need assistance.

Content Sheet

CRMEATR-10R -- CTN: MEA CRV-SIDE FRAME COMP

| Pic # | | | DESCRIPTION |
|------------------|----|----------|--|
| | 1 | 22-10075 | HDW SS #10X1 PHILHX WSHR SCREW 99-0070 QTY-64 |
| | 1 | 22-10129 | HDW SS #10X1-1/2 PHIL TRUSS SCREW 99-0088 QTY-20 |
| 6 | 10 | 22789 | TR PEARL RESIN CMN 56" INFINITY |
| Packaging | | | |
| | 1 | 97-1357B | CARTON-EMPTY [2XT] ID 58-1/16X20X9-5/8 ECT48 BOT |
| | 1 | 97-1357T | CARTON-EMPTY [2XT] ID 58-5/16X21-1/2X9-3/4 ECT48 TOP |
| | 2 | 97-1365 | CARTON-SCORED SHEET [2XXT] 78-1/2 X19-3/4X13-1/2 ECT48 |

NOTICE: Please make sure you save this document with your original pool purchase records. It contains vital information to assist us in identifying your pool should you ever need assistance.

Content Sheet

CRMEAUP54-10 -- CTN: MEA 54" CRV-SIDE FRAME COMP

| Pic # | | | DESCRIPTION |
|------------------|----|----------|--|
| 5 | 10 | 21411 | UR 9" DAMASK 53 13/16" (OCN) |
| Packaging | | | |
| | 1 | 97-1357B | CARTON-EMPTY [2XT] ID 58-1/16X20X9-5/8 ECT48 BOT |
| | 1 | 97-1357T | CARTON-EMPTY [2XT] ID 58-5/16X21-1/2X9-3/4 ECT48 TOP |

NOTICE: Please make sure you save this document with your original pool purchase records. It contains vital information to assist us in identifying your pool should you ever need assistance.