

# Diamond Star Round

Saltwater Friendly

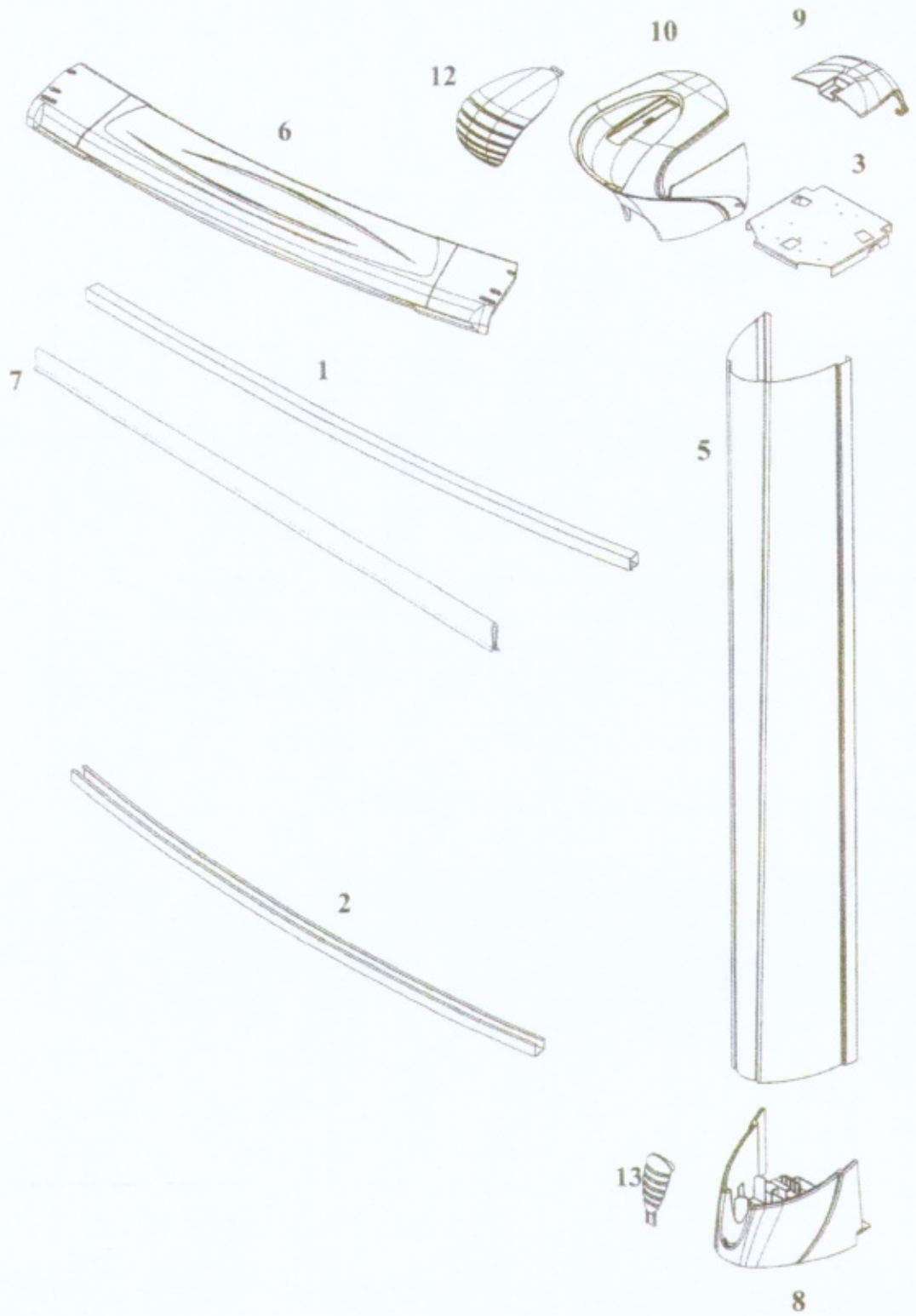

# WBI Pool Breakout

**PMEA-1854RPRRRE1**

MEADOWS ROUND 18 Ft 18-54 RPRRRE1

**Features:** ROUND  
Size: 18 Ft  
Depth: 54

10.00

**Structure Composition**

RESIN - PEARL Top Ledges  
PAINTED STEEL - DAMASK Uprights  
RESIN Bottom Rails  
RESIN Stabilizers  
RESIN Bottom Plates  
STEEL Top Plates

*Note: Double click on carton product search key to see content sheet*

Qty	Carton Part #	Carton Content Description
1	CRMEA18-RRRE1	CTN: MEA 18 MIXED CRV/STR COMP
1	CRMEATR-12R	CTN: MEA CRV-SIDE FRAME COMP
1	CRMEAUP54-12	CTN: MEA 54" CRV-SIDE FRAME COMP
1	*** WALL ***	Wall - Depth: 54" Size: 18 Ft

10/3/2022

**Content Sheet**

**CRMEA18-RRRE1 -- CTN: MEA 18 MIXED CRV/STR COMP**

<i>Pic#</i>			DESCRIPTION
7	14	10296	PLASTIC COPING SINGLE 48" FOR METAL STAB
2	12	12321	BTM RAIL (LX) PRL RESIN 9'0" R CMN 54-1/4" BLACK
10	12	21378	TC 10" DAMASK OUTER HALF CVD [E1]
9	12	21380	TC 10" DAMASK INNER HALF [E1]
8	12	21381	TC 10" DAMASK BOOT CVD [E1]
3	12	21564	TOP PLATE 9" OCEANIC
1	12	29890	RIM 5/8" SQ RSN 9'0"R 56-1/16" BLACK
1	12	29931	INR STAB SQ RESIN CONNECTOR 5 1/2"
	1	36879	SHARKLINE CONSUMER DVD
12	12	38105	TC 10" MEADOWS CAP GRILL TAN PPC
13	12	38106	TC 10" MEADOWS BOOT CUFF GRILL TAN PPC
	1	44-10310	HARDWARE POOL KIT SS 310
	1	910029	SHARKLINE WARRANTY TERMS & CONDITIONS
	1	95-0007	ENVELOPES SAFETY COMPLETE
<b>Packaging</b>			
<b>1</b>	<b>97-1357B</b>		CARTON-EMPTY [2XT] ID 58-1/16X20X9-5/8 ECT48 BOT
<b>1</b>	<b>97-1357T</b>		CARTON-EMPTY [2XT] ID 58-5/16X21-1/2X9-3/4 ECT48 TOP
<b>2</b>	<b>97-1365</b>		CARTON-SCORED SHEET [2XXT] 78-1/2 X19-3/4X13-1/2 ECT48

**NOTICE:** Please make sure you save this document with your original pool purchase records. It contains vital information to assist us in identifying your pool should you ever need assistance.



**Content Sheet**

**CRMEATR-12R -- CTN: MEA CRV-SIDE FRAME COMP**

Pic #			DESCRIPTION
	1	22-10096	HDW SS #10X1 PHILHX WSHR SCREW 99-0070 QTY-72
	1	22-10131	HDW SS #10X1-1/2 PHIL TRUSS SCREW 99-0088 QTY-24
6	12	22789	TR PEARL RESIN CMN 56" INFINITY
<b>Packaging</b>			
	1	97-1357B	CARTON-EMPTY [2XT] ID 58-1/16X20X9-5/8 ECT48 BOT
	1	97-1357T	CARTON-EMPTY [2XT] ID 58-5/16X21-1/2X9-3/4 ECT48 TOP
	2	97-1366	CARTON-SCORED SHEET [2XXT] 78-1/2 X19-3/4X15-1/2 ECT48

**NOTICE:** Please make sure you save this document with your original pool purchase records. It contains vital information to assist us in identifying your pool should you ever need assistance.

**Content Sheet**

**CRMEAUP54-12 -- CTN: MEA 54" CRV-SIDE FRAME COMP**

Pic #			DESCRIPTION
5	12	21411	UR 9" DAMASK 53 13/16" (OCN)
<b>Packaging</b>			
	1	97-1357B	CARTON-EMPTY [2XT] ID 58-1/16X20X9-5/8 ECT48 BOT
	1	97-1357T	CARTON-EMPTY [2XT] ID 58-5/16X21-1/2X9-3/4 ECT48 TOP

---

**NOTICE:** Please make sure you save this document with your original pool purchase records. It contains vital information to assist us in identifying your pool should you ever need assistance.